

The Link

Quendon & Rickling
Parish
and Church

You can find *The Link*
and much more at
www.quendonandrickling.co.uk

NEWS

April 2021

In this issue

Church Contacts	2	Council Chairman	5	Neighbourhood Plan	9
Vicar's Message	2	Member of Parliament	5	Crime Prevention	10
Cover pictures	2	District Council	6	School Governor	12
Church Services	3	100 Club	7	Emergency Life-saving	13
Police Contacts	3	Choral Society	7	Redundancy Help	13
Community Café	3	STOP PRESS	7	Publication Details	14
AED Life-savers	4	Hundred Parishes	8	What's On	14
Bowls Club	4	Pumpkin Competition	8	Saffron Screen	14
Village Hall	4	Security Advice	9		

*Early Daffodils
by Peter Warwick*



Visits: If you would like the Vicar to visit you at home or in hospital, or know of anyone who would like him to visit them, please let the Vicar know.

The Rev'd. Neil McLeod, The Vicarage, 5, Meadowford, Newport, Saffron Walden, Essex, CB11 3QL

Telephone: 01799 540339 **E-mail:** vicar4nqrwchurches@gmail.com

From the Vicarage Study

Rev. Neil McLeod,

Priest-in-Charge of Newport with Widdington, Quendon and Rickling.



There is light at the tunnel, and I believe that we are now in a position to see the end of the tunnel that is the covid-19 pandemic. We still have a long way to go but the rollout of the vaccines is going very well – I received my first dose of the Oxford/AstraZeneca vaccine on Monday 8th March. I know, from talking to people, that a lot of people in the area from what are deemed to be the vulnerable groups have been going to either the Lord Butler Centre or Bishops Stortford to receive their vaccine.

The date of 21st June has been set for the lifting of the majority of the restrictions, which is fantastic. Clearly that date is aspirational and a great deal depends upon how we, the general public, behave between now and then. We must still follow the social distancing guidelines, wear masks, etc. From 29th March we can meet in groups of 6 outdoors; I've got family meetings in the vicarage booked for Easter.

Talking of Easter, the churchwardens and I met last week to discuss the reopening of our church buildings. As you may know we closed our church buildings following instruction from the diocesan Bishop, which was itself based upon advice from Essex Health Authority. The case numbers in Essex were among the highest in the country so we closed our church buildings after Christmas. We have taken the decision to reopen on Easter Sunday. This is an appropriate day to open as Easter itself talks of new hope and new life based upon Jesus's resurrection from the tomb. My prayer is that we can look for that new hope as we follow the government's roadmap out of lockdown.

All services prior to Easter Sunday on Palm Sunday, Maundy Thursday and Good Friday will be held on Zoom. They are detailed elsewhere in this magazine, and if you wish to join any of the services online please email me on vicar4nqrwchurches@gmail.com The Easter Sunday services will be:

- 10.00am, Online All-Age Service via Zoom
- 10.00am, Morning Worship, Quendon
- 10.00am, Holy Communion, Widdington
- 4.00pm, Holy Communion, Newport

Unfortunately restrictions will still apply meaning that there are restricted numbers allowed in the church building to allow for social distancing, and we will still have to wear masks during the service. I believe that there will still be a restriction on congregational singing. But it is great that we are in a position to be able to open up the church buildings, come together and worship together.

Due to reduced numbers allowed in the church buildings you must please reserve a place for you and your household. Places will be allocated based upon the size of your household group. Please either email me (details above) or call me on **01799 540339** to reserve spaces.

Until then, please stay safe. God bless.

Revd Neil McLeod

Cover pictures for The Link

Share your favourite pictures for our front cover by sending them to The Editor at robert@arnold-q.uk. Please remember, though, that privacy considerations must be respected and image resolution needs to be high enough for printing at the right size.

Priest in Charge of Newport with Widdington and Quendon and Rickling.

The Rev'd. Neil McLeod, The Vicarage, 5, Meadowford, Newport, Saffron Walden, Essex, CB11 3QL

Telephone: 01799 540339 E-mail: vicar4nqrwchurches@gmail.com

Churchwardens - Quendon: Mrs Christine Osbourn 01799 543367 and Mrs Maureen Hawkins

Rickling: Lisa Huxtable 07771 541944

Treasurer - Quendon and Rickling: Mrs Sandra Arnold 01799 543075

Church Services in the Benefice

Thursday 1st April – Maundy Thursday

7.30pm **Online - Zoom - Holy Communion**

Friday 2nd April - Good Friday

10.30am **Online - Zoom - Messy Easter**

2.00pm **Online - Zoom - Hour of the Cross**

Sunday 4th April - Easter Sunday

10.00am **Online - Zoom - All-Age Service**

10.00am **Quendon Morning Worship**

10.00am **Widdington Holy Communion**

4.00pm **Newport Holy Communion**

Sunday 11th April

10.00am **Online - Zoom - Contemporary Communion**

11.00am **Quendon BCP Communion**

Sunday 18th April

10.00am **Online - Zoom - Morning Worship**

11.15am **Widdington Holy Communion**

Sunday 25th April

8.30am **Newport BCP communion**

9.30am **Online - Zoom - Holy Communion**

11.00am **Rickling Holy Communion**

Sunday 2nd May

10.00am **Online - Zoom - Contemporary Communion**

11.00am **Widdington Family Service**

Sunday 9th May

10.00am **Online - Zoom - All Age Service**

11.00am **Quendon BCP Communion**

Sunday 16th May

10.00am **Online - Zoom - Holy Communion**

11.00am **Widdington Holy Communion**

Sunday 23rd May

8.30am **Newport BCP communion**

10.00am **Online - Zoom - Morning Worship**

11.00am **Rickling Holy Communion**

Sunday 30th May

10.00am **Online - Zoom - Morning Worship**

10.00am **Widdington Holy Communion**

Please contact the Vicar at vicar4nqrwchurches@gmail.com or on **01799 540339** to reserve a place for ANY of these services, whether in a church building or by Zoom.

Police contact information

For crimes and suspicious activity **NOW** phone

999

For non-urgent incidents and reporting a crime that has already happened

101

Alternatively you can report non-urgent incidents or suspicious activity and crimes on-line at <https://www.essex.police.uk/do-it-on-line/>

Action Fraud is the UK's national reporting centre for fraud and cybercrime where you should report fraud if you have been scammed, defrauded or experienced cyber-crime in England, Wales and Northern Ireland.

If you have been defrauded i.e. lost money phone or report online at

<https://www.actionfraud.police.uk/reporting-fraud-and-cyber-crime>

If someone has tried to defraud you but you have not lost money, phone or report online at <https://www.actionfraud.police.uk/report-phishing>

0300 123 2040

To give information **anonymously** phone CRIMESTOPPERS or report it on-line at www.crimestoppers-uk.org

0800 555 111

Rickling/Quendon Community Café

Quendon & Rickling Village Hall, Quendon, CB11 3XQ

Quiz and Fun Bingo

Hi everyone.

I hope you are all keeping well and looking forward to being able to come along to the coffee mornings again.

Unfortunately, we have lost a few of our older members through the pandemic and when we reopen we will all raise a cup of tea and remember our very dear friends.

Hopefully we will be able to hold our first meeting of the year in the summer (Will let everyone know) and have great plans for reaching more people in villages near by. So everyone welcome.

Watch this space and stay well.

Please contact: Angie and Carole 01799 543807/218061

Emergency Life Saving

Readers will be familiar with the feature towards the back of *The Link* each month giving details of those helpers to contact should there be a need of the Parish Defibrillator. There is more information on the parish website at <https://www.quendonandrickling.co.uk/local-information/save-a-life/>.

Should someone suffer a cardiac arrest or show symptoms of a heart attack e.g. pains in the chest, then your first action should always be to phone the ambulance service on 999. The service should tell you the key code for our Automated External Defibrillator ("AED") which is in a secure box at the front entrance to Quendon & Rickling Village Hall. Anyone can save a life by using it until an ambulance arrives. It is not essential to ask for the help of one of the volunteers, as the AED really is fully automated, but they can give additional help and support.

We need an additional volunteer to cover the Rickling Green area. Volunteers are given an introduction to the AED, including the key code and are shown how easy it is to use it. They can then help and give reassurance in case the device is needed. Anyone interested should contact our Defibrillation Co-ordinator on 07876 331710 or by e-mail at andrew.d.thomson@btinternet.com for more information.

Parish Information

Welcome Packs

The Parish Council provides a Welcome Pack of information for new residents to the Village. If any newcomers to the village have not received a copy of the pack, do please let the Clerk know on the contact details below and a welcome pack will be provided. It would help if an e-mail address could be provided to enable the pack to be sent digitally.

Allotments (part of the Quendon Hall Estate):

- Peter Warwick, No.5 Thistley Crescent, Green Road, Rickling
- Telephone: 01799 543526

Highway Problems

The Essex Highways website is available for anyone noticing a problem to report it: <http://www.essexhighways.org/Report-a-problem.aspx>
A tracking facility for all reported faults is available.

Police/Crime

The Essex Community Messaging Service provides useful information to the public about policing and safety issues. It is free to register and information is given relative to your postcode, thus providing accurate and up-to-date community safety information and crime prevention advice. Users can choose to receive information via e-mail, text or voice-recording and can select what information to receive – based on where they live and work and on issues of interest. For further details and to sign up, visit www.essex.police.uk/ecm

Contact the Parish Council

The Clerk, Keith Williams can be contacted by e-mail at quendonandrickling.clerk@hotmail.com or by telephone 01279 814473

Quendon Bowls Club



Did you know that there has been a bowling green in Quendon for more than 75 years? It has an outstanding green and excellent refurbished club house with good facilities and licensed bar. The club house is available to hire for suitable functions i.e. Birthdays, Anniversaries etc.

As we approach the Bowling Season, and trust that we will be able to play again soon, we invite young and older people who feel interested in joining to contact John Parker on 07834742704 or jvparker50@gmail.com.

Quendon Bowling Club will be taking part in the National Open Weekend organised by our governing body Bowls England during the weekend of 28th to 31st May. More details to follow.

Village Hall

Following the Government and Village Hall guidelines; The hall can be reopened on May 17 provided there are no further outbreaks of Covid 19.

We look forward to seeing everyone again.

Advertising in

The Link

**reaches every household in Quendon and Rickling
at attractive rates**

**This space could be promoting
YOUR business**

Many other options are available

**Contact Advertising preferably by e-mail at
sandra@arnold-q.uk, or telephone 01799 543075**

From the Chairman of the Parish Council

Dear Fellow Villagers!

Well, this is an exciting month – April 2021!!! We are allowed out to meet people and we can return to The Cricketers Arms for an outdoor drink, the first one this year!! What a year this has been!

The Quendon trees have finally been planted - what a performance! We can't wait to see the first green shoots appear. They are being watered and cared for by a local tree arborist/surgeon, so they should be in good hands this time.

As you will probably have seen, the 40mph buffer zone has been implemented on the B1383. We have raised a couple of questions with Essex Highways though - the pole (north bound) outside Monarch's Place (Foxley 2) is half the height of the one on the opposite side of the road (south bound), this is being dealt with by Stonebond (the developer) directly with Essex Highways. We have been assured that both poles will be the same height by the time the development is complete. We have also raised the question with Essex Highways about why there is only one 40mph sign at the beginning of the buffer zone and not two!

There was much discussion at our last meeting regarding the Wildlife Friendly Village. We have co-opted one of the previous councillors, Paul Wilsher and he will become our Wildlife Friendly Village advisor and eco warrior! We plan to keep it very simple in the first year and see what flowers and grasses grow naturally. We also plan on planting bulbs around the new trees by the fountain in the autumn. Paul will also be doing a monthly "blog" in The Link, starting in May, so keep your eyes open for advice on wildlife friendly gardening, building, planting to encourage wildlife etc.

Along these lines, Forsters Footpath is due for a bit of TLC and Stonebond have offered to remove the old posts and wiring ready for one of our residents to plant some hedgerow trees, which she has ready and waiting in pots. With all this new planting, it is going to be a real wildlife haven! We are sure that she will need some help, so any volunteers will be very welcome.

Following the Spring Litter Pick in March, one of our Councillors, Jennie Sutton, is setting up a monthly litter

pick, so volunteers are also needed for this! You don't have to commit to helping every month, just whenever suits you. Information will be put in future editions of *The Link* and also on Facebook.

On the Events front, we hope you enjoyed your waffles, whether they were savoury or sweet – it does make a difference when someone else is doing the cooking! Also just to say there is still time to enter the Pumpkin Growing Competition - seeds are still available to purchase from the Parish Council. We are really looking forward to judging some very interesting pumpkins in October!

We would like to say a big thank you to Tracey Hepting for all her help with the Events Team and with Speedwatch. She has put in an enormous amount of time and energy in both and will be missed. Also, a big thank you to Pat Turner for her contribution on the Defibrillator Team, consequentially there is a vacancy on Rickling Green, so if anyone would like to step into Pat's shoes, please let us know.

Sport will be up and running again in April! The football pitch has been mown and fertilised and will be in peak condition, ready for the new season to start the weekend of 3/4 April.

The Cricket Pavilion is in the process of being restored, perhaps by the time you read this, it will be finished ready for the season to begin at the end of April. There are numerous matches organised and it will be lovely to see the teams of white on the green again. The Pavilion is also going to be the proud owner of a giant new clock so everyone all around the Green will have no excuse to be late again!

The Cricketers Arms is opening on 12 April for outside reservations and 17 May for indoor so please do go and buy a pint or treat yourselves to one of their delicious meals! The pub is an integral part of the village and the green, we can't afford to lose it!

Finally, we look forward to seeing the beginnings of normality returning to the village! Cheers!

Sally Kitcat

Our Member of Parliament

Face to face surgeries for you to meet with me, your Member of Parliament, and seek advice or assistance on confidential issues are not currently possible. For all enquiries please send an email or speak over the phone.

How to contact me

Email: kemi.badenoch.mp@parliament.uk

Tel: 0207 219 1943

Write: Kemi Badenoch MP,
House of Commons,
London, SW1A 0AA

Kemi Badenoch, MP



Report from District Councillor Neil Hargreaves

Elections on 6th May

These are for the Police Fire and Crime Commissioner, for Essex County Council, for the Newport Ward district council by-election, and probably the referendum to adopt the Neighbourhood Plan. So, we will have four voting papers! All of these elections have been delayed by covid.

For the County election Uttlesford has four 'Divisions'; Dunmow, Saffron Walden, Stansted and Thaxted. Our Stansted one has 16,600 voters and stretches all along the B1383 from Birchanger to Newport and west to Clavering and the Stort valley. R4U is for the first time standing candidates in all four Divisions. Our candidate for here is Bianca Donald, who is a teacher and lives at Elsenham. At the time of writing no other party candidates have been declared, although it is assumed that the current incumbent Ray Gooding will be standing.

The Newport by-election is to fill the vacancy which has existed for over a year in what is a two-councillor ward. Having looked after things on my own during that time, I am looking forward to getting back up to strength! R4U is standing Judy Emanuel, who is Vice Chair of Newport Parish Council. The other candidate announced to date is Jennie Sutton, who stood for Stansted South in 2019.

Neighbourhood Plan

After four years we have finally arrived. And the good news is that the Plan will have full weight in relation to planning applications. Uttlesford has a 3.11 year supply of housing permissions. For a district wide Local Plan, the requirement is a five-year supply, otherwise there is a presumption towards giving permission for developments outside of agreed development limits. But for a Neighbourhood Plan the requirement is only three years. So, we will have an up-to-date Neighbourhood Plan and with the requisite housing supply there will be a presumption against building outside of development limits, except for buildings meeting various criteria.

On the map here the black line is the development limit, and the red line is the Conservation Area.

The Plan policies include ones on retention of sports facilities and provision of community facilities, housing design, extension of footways, protection of views, high speed internet connection, parking standards, affordable housing and support of businesses.

One of the key policies is

NQRHA1 – Coherence of the villages

Development of sites within the Development Limits will be supported if of a scale and setting relating well to the villages, with good vehicle access and where safe, convenient pedestrian and cycle access is in place providing good connectivity from residential areas to the village centres and bus stops and, in Newport, the railway station

Further development outside of the development limits shown in the Development Limits maps, will not be supported other than;

- Development appropriate for a countryside location, defined as agriculture, horticulture, forestry, outdoor recreation and other uses which need to be located in the countryside.*
- Small scale infill development within existing clusters of development;*
- Affordable housing on rural exception sites to meet an identified local need which cannot be met in any other way including some market housing necessary to secure the viable delivery of the affordable homes*
- Residential conversion of redundant or disused rural buildings, which will enhance their setting*
- Subdivision of an existing dwelling*
- Construction of new houses of exceptional design meeting the criteria set in paragraph 79e) of the NPPF*
- Conversion of existing buildings and the erection of well- designed new buildings for business uses.*

This does not prevent new development outside of limits, even large scale. Decisions are made by balancing the pros and cons, and how they fit with local and national policy. However, this policy will carry significant weight

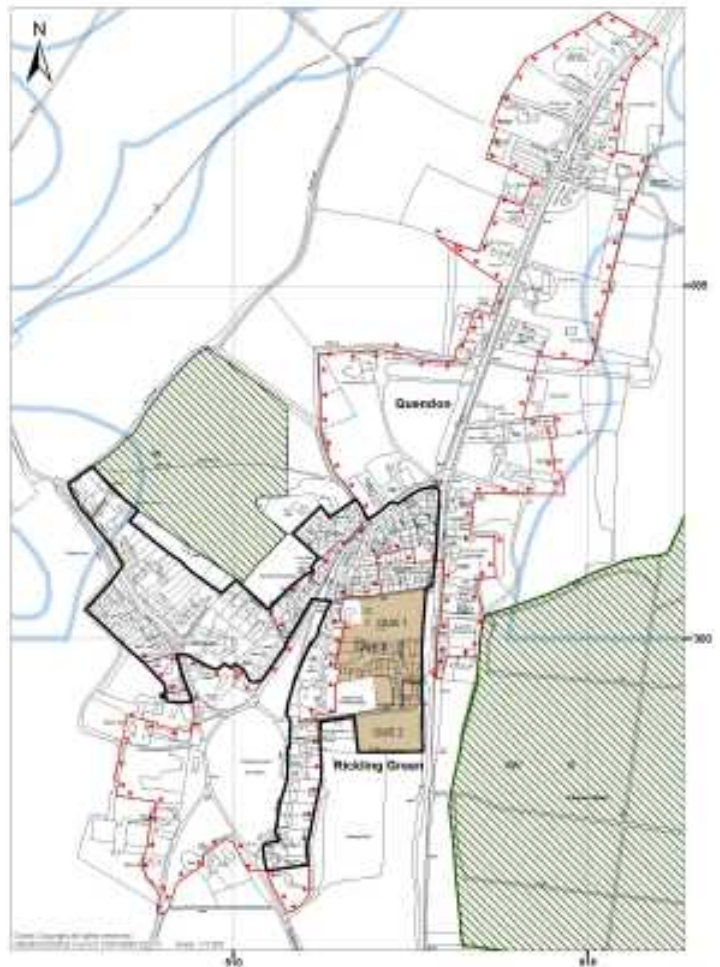

Report from District Councillor Neil Hargreaves (cont.)

in such decisions. The Plan is at <https://www.nqrplan.org/>

There is still a small doubt as to whether the referendum will be ready for May 6th. This is because it had to be taken back for a further external examination over the removal of three words from HA1. The examiner has just agreed to the change (which is already in the text above) but there is a procedure to go through, but I think the deadline will be met, otherwise the referendum will take place a little later.

Councillor Surgeries

These are currently suspended but I'm available on **01799 540411** and on the village Facebook and by email at cllhargreaves@uttlesford.gov.uk.

Neil Hargreaves

Other News from Uttlesford District Council

You can get email newsletters and alerts on a whole range of topics via Keep me posted – sign up and find out more at www.uttlesford.gov.uk/keepmeposted.

STOP PRESS (on-line edition only)

See page 9 for more on the Neighbourhood Plan

Saffron Walden Choral Society - in lockdown!

Saffron Walden Choral Society is still active, meeting 'virtually' on Monday evenings, despite the lockdowns. Via Zoom, we keep our vocal chords active, with a mix of new and familiar music. Our repertoire is mostly but not exclusively 'classical' in the broadest sense.



Of course, it is not the same experience and the choir is really looking forward to meeting in person and performing for an audience again, just as soon as possible. Our regular concert venue over the past eight years has been the impressive Saffron Hall.

Meanwhile, if you have some experience of choral singing and you want to try us out, get in touch at membership@swchoral.org.uk and we'll share a link to join one of our 60 minute Zoom sessions. We start with a short warm up to keep in good vocal shape, then work on a variety of music, including some classics of the choral repertoire.

Here are some comments from our members:

'Singing is a great stress reliever and it's so nice to see everybody'

'I look forward to Monday evening rehearsals, it is really good to use my singing voice and lovely to still feel part of the choir. Love the socials too.'

For a brief introduction to our style, please watch the beginning of our 2020 Spirit of Christmas videos – episode 1.

YouTube link: https://www.youtube.com/watch?v=CREodMcBJVM&ab_channel=SaffronWaldenChoralSociety

You can find links to all episodes on the news page of our website: <http://www.swchoral.org.uk/news/>

You can also get in touch via the website - we'd love to meet you.

Janet Wheeler MD



YouTube QR Code

Quendon & Rickling 100 Club

Congratulations to the March 2021 Winners

1st	P Waites	£35
2nd	C Foulser	£25
3rd	T Deriziotis	£15

Quendon & Rickling 100 Club generates a source of funds for the Village Hall and both our two churches, All Saints, Rickling and St Simon & St Jude, Quendon.



THE HUNDRED PARISHES SOCIETY

www.hundredparishes.org.uk

Guilds were an early form of trade association. They became established in the Middle Ages by groups of merchants to control standards and promote their particular craft or skill in the locality in which they operated. Some acquired sufficient funds and status to erect their own premises or Guildhalls in market towns. These buildings were used for meetings and other functions by the guilds. Some were designed to allow markets or trade on the ground floor.



The Hundred Parishes has some wonderful surviving examples of guildhalls. Thaxted is probably the best known - three storeyed, timber framed and jetted, built in the 15th century. Thaxted was an

important centre of cutlery manufacture and it is believed the cutlers helped to fund the building we now know as the Guildhall. Its original purpose is uncertain; it may have had broader uses as a moot hall or civic meeting place. The building later became a school and today it is used for parish council and other meetings and incorporates a small museum of Thaxted's history.

The guildhall at Linton was



built in 1523 and is now a private house. It was once the home of Sir John Kendrew who was awarded the Nobel Prize for Chemistry in 1962.



Finchingfield's 15th-century guildhall stands beside the parish church. In the past it was used as almshouses and now the renovated building houses a library and excellent museum. The first floor is used in non-Covid

times for courses and is available for private hire.

In Church Lane Clavering you will find a 15th-century timber-framed and plastered building. Now a private dwelling, it was built as the guildhall and later served as a workhouse and then almshouses.



Ashdon's former 15th-century guildhall, behind the church, also later served as a workhouse before becoming a private house.

Ken McDonald, Secretary

A Quendon & Rickling Parish Council led Event

Quickling Village Pumpkin Competition

Thank you to all those who have already expressed an interest in entering our first Quickling Pumpkin Growing Competition and purchased seeds.

★ SEEDS ARE AVAILABLE

- All Ages Welcome
- Test your growing skills
- £2.50 Entry Fee
- 3 seeds per competitor will be provided, to be sown either indoors March-May or outdoors March-June, for the Grand Finale Weigh-In in October.

Details will be announced later in the year as to how the weigh in will be carried out

- Prizes to be awarded for the heaviest Pumpkins

- ★ Following on from this we would also like to announce that we will also be running a separate competition to find the best carved pumpkin for Halloween!



Please contact Carrie Williams or Katherine Nuthall to register (knqrpc@gmail.com).

HAPPY GROWING!

Security News and Advice from Stephen Armson-Smith, Braintree & Uttlesford Crime Prevention Officer - 090819

Spring Garden Security Advice Part 2 – Sheds, Garages and Objects

We spoke last month about garden security now we look at the shed, garages and objects within it. As mentioned before controlling access is your first line of defence and you may consider using good old gravel on paths and drives or round statues etc as an audible warning and/or a "Driveway Alert Monitor" (can be found by internet search). Sensitive and effectively placed lighting and CCTV may be considered to help protect outbuildings, ornaments, and statues but these should not be your only thoughts. Don't forget though that motion activated lighting may be triggered by animals and shrubs moving in the wind.

Shed and outbuilding security: If you are installing a new shed try and find a place in view of the house and neighbours. The padlock hasp fittings of a shed should be coach-bolted to the frame and door, strengthen the fitting area with a metal plate inside and out; don't forget the hinges - ensure they cannot be unscrewed. Cheap locks and padlocks are a poor investment; use good quality locks, look for a "Close Shackle" padlock or a key operated mortice lock to at least "Sold Secure" Silver or Gold standard. Protect windows with a wire mesh and fit a curtain or whitewash the windows to prevent prying eyes. NB some of this advice can apply to aviaries, kennels, barns and other buildings of similar nature.

On garage doors consider adding locking bolts to both sides of an "up and over door" or a garage door defender in the ground in front of the door. Don't forget other doors and windows in the garage secure them as you would in a house. **LOCKS ARE A WASTE OF TIME IF YOU DO NOT LOCK THEM.**

When storing larger items like motorcycles, cycles, lawn mowers etc., consider a fixing set/ground anchor into the concrete floor, a heavy chain and again a good quality padlock to secure it. If the chain or lock is lying across the floor it could provide a surface for it to be smashed against so try and keep it tightly secured. Consider a shed alarm if you do not have one; there are shed alarms

available that contact you on the phone when activated such as www.uwatch.co.uk.

Products that are fit for purpose can be found by looking for the "Secured by Design" or "Sold Secure" logos, or on their websites www.securedbydesign.com or www.soldsecure.com.

Tips for Statues, ornaments and pots:

- Drill and secure with quality chain/padlock larger pots and ornaments to a secure surface.
- Offenders will not want to break valuable containers- however they may still opt to lift out the plan - this is where the Plant Anchors can help.
- Make the plant pot heavier with a layer of gravel at the bottom.
- Some planters/pots can be marked/post-coded /etched carefully with a small "hobbyist" drill or an indelible pen can work sometimes on the base.
- Hanging baskets can be secured with chains or cable ties BUT there is a danger the offender may simply wrench from the fixing point making even greater damage.
- Where possible position statues, ornaments etc in view of the house and neighbours.
- Photograph more unusual ornaments with a scale rule included, and where possible ensure these ornaments are in view of a house and have good lighting. Consider using a property marking product
- Only buy plants/ornaments from a reputable source and report any suspicions to Police/Trading Standards.

For further garden security advice see the following webpages:

www.essex.police.uk/cp/crime-prevention/
www.securedbydesign.com
www.soldsecure.com
www.rhs.org.uk/advice/profile?pid=606

If only warning messages like this were shared 37,000 times in a day!

'Tell2, protect many' is a communication initiative that empowers you to spread crime prevention messages to others in your life, who otherwise may never know. Start with 'tell2' and ask them to do the same. It starts with YOU!

If you or someone you know is vulnerable and has been a victim of fraud, please call Essex Police on **101**.

Report fraud or attempted fraud by contacting Action Fraud at www.actionfraud.police.uk or call **0300 123 2040**.

Neighbourhood Plan

As noted in Cllr. Hargreaves's report above, there will be an additional voting paper on the 6th of May.

Former Parish Council Chairman Brandon Chapman has been a member of the Neighbourhood Plan Steering Group. He strongly recommends that you vote in favour of the Newport Quendon and Rickling Neighbourhood Plan in the referendum on May 6th.



TICKET SCAMS

Following the announcement that the UK will see a phased exit out of lockdown, the demand for tickets for summertime events has soared - along with the opportunities for scammers.

With the expectation that the UK will be 'open for summer' there has been a rush to make the most of it. Many people are looking to attend festivals and live events, but many are falling prey to the criminals looking to profit from this demand.

Essex Police have recently seen an increase in reporting where residents have purchased a ticket and been requested to pay via bank transfer or PayPal Friends and Family. When they arrive at the address to collect the tickets, the homeowner is unaware of the sale, or the tickets never arrive by post.

How to protect yourself from ticket fraud:

- Buy from genuine ticket sellers (i.e. box office/promoter/reputable ticket site) - whilst you may be able to pick up a 'bargain' via social media, there is no guarantee you will receive the tickets. It's much more expensive to have to pay twice!
- Avoid bank transfers - requests for bank transfers or via PayPal Friends and Family should be a red flag. Using these methods offers little protection should something go wrong.
- Beware of unsolicited contact - be suspicious of emails, texts or social media offers of unbelievably good ticket deals.

Remember - if it seems too good to be true, it probably is!

On a similar theme..

Action Fraud warning as holiday bookings surge after lockdown exit plans announced.

Action Fraud and ABTA, The Travel Association, are reminding the public to think twice before handing over their money and personal information when booking holidays this year.

What is holiday fraud?

Holiday fraud can vary from fake accommodation listings that don't actually exist, to "too good to be true" offers with flights being particularly targeted. Criminals can approach you over the phone, via text, email and social media, offering incredibly cheap deals to tempt you into booking a holiday with them. In reality, the holiday you've booked, or parts of it, doesn't exist at all.

Before you buy:

- Do your research—make sure you've read plenty of reviews and have checked that the company is an ABTA member

- Pay Safe—use a credit card where possible and avoid paying into bank accounts
- We've said it before: if it's too good to be true, it usually is!

CAR OIL TRICK

Car sellers are warned to be on the lookout for a re-emerging scam that sees potential buyers try to knock thousands off a car's asking price—by tampering with its engine.

The scam, which has been around for a number of years, sees criminals secretly pour oil into the coolant reservoir of the vehicle for sale, then request a large discount claiming it will require a new engine.

The scammers often arrive to view the car in pairs or threes and will try and distract the seller—one may ask to look at the engine whilst the other wants to see the spare tyre in the boot. When the car is taken for a test drive, the engine may smoke or make loud noises, which will prompt the scammers to ask for a cut-price deal.

Recently, Essex Police has seen an increase in the number of reports of this scam, both within Essex and in surrounding counties. If selling a car, remember:

- Stay with the buyers - don't leave them alone with the car or allow yourself to be distracted at the rear of the vehicle whilst someone is looking at the engine
- Be aware of suspicious behaviour - scammers will often request an enormous discount due to the 'fault' with the vehicle
- Be confident to refuse the sale - if you are doubtful about how genuine the buyer is, or you believe that something suspicious is going on, don't hand over the keys!

FAKE NATIONAL INSURANCE CALLS

Following a surge in reporting to Action Fraud, Essex has also seen an increase in automated National Insurance scams.

Residents have reported receiving an automated telephone call telling them their "National Insurance number has been compromised" and in order to fix this and get a new number, the victim needs to "press 1 on their handset to be connected to the caller".

Once connected to the "caller", they are pressured into giving over their personal details in order to receive a new National Insurance number. In reality, they've been connected to a criminal who can now use their personal details to commit further frauds. Remember:

STOP - Taking a moment to stop and think before parting with your money or information could keep you safe.

CHALLENGE - Could it be fake? It's ok to reject, refuse or ignore any requests. Only criminals will try to rush or

CRIME PREVENTION (cont)

panic you.

PROTECT - If you have provided personal details to someone over the phone and you now believe this to be a scam, contact your bank, building society and credit

card company immediately and report it to Action Fraud at www.actionfraud.police.uk or by calling **0300 123 2040**.

BITCOIN

Bitcoin has recently seen record highs, the FCA has issued a warning to all would-be investors in cryptocurrencies to 'be prepared to lose it all'. Cryptocurrencies are not covered by investment regulation, so there will be little protection if the investment goes wrong.

It is expected that fraud criminals will seek to maximise on the sudden interest in Bitcoin and cryptocurrencies by flooding the market with crypto investment scams.

It is believed that fraudsters are likely to begin setting up fake cryptocurrency firms in order to lure people into investing in what they believe to be a genuine product.

Residents should be wary of investment offers that come out of the blue, where they are pressured to invest quickly, or are promised returns that seem too good to be true.

For further advice visit www.fca.org.uk or search FCA Cryptoassets in your search engine.

If you are worried about Dog thefts, take part in the national survey from the Association of Police and Crime Commissioners, designed to understand public perception of dog theft, enforcement and the prosecution of offenders: <https://www.surveymonkey.co.uk/r/dogtheft>

CAN YOU HELP?

We are having a number of on-going problems around the

district with off-road motor cycles and quad bikes etc., driving across farmers' fields churning up the ground and damaging crops that have been planted. Some are also using public rights of way illegally, including some byways which have been temporarily closed by Essex County Council. Most of these irresponsible people will be riding unregistered off-road bikes and not have any insurance, so are probably being brought into the area in vans or similar vehicles.

This is where we could do with your help. Looking for a few motorbikes in the countryside is very difficult to do, but if we can ascertain where they start from, then we have more chance of catching them and identifying who they are. If you see a van parked up in an unusual spot, perhaps near to a footpath or by-way etc., can you please let me know by email.

I will collate your responses with a view to letting the CPT and Rural Engagement team know of potential drop off points for these off-landers, so we can then pay attention to these areas and try to deal with any offences before they set off or return.

Please can you give me the day, date, time and location (using the what3words* app if possible), together with colour, make and model of the van, and if possible the registration number. Please ensure however, that you do not put yourself in any danger.

Please note that there are genuine green-laners and off-road clubs that respect the countryside and use open by-ways legally. We only want to catch those that are acting illegally or in an anti-social manner

*N.B. what3words is a free smartphone app that uses a combination of three unique words to easily pinpoint a location anywhere in the world. Visit <https://what3words.com/> for further information.

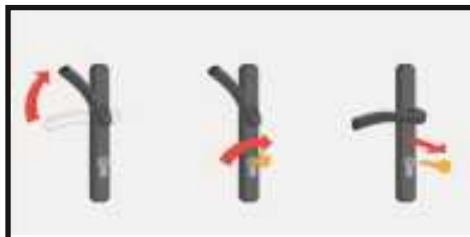

Simply shutting the door won't prevent burglaries. Double-lock the door every single time you leave the house.

Modern multi-locking and uPVC doors use a system of hooks and latches to secure the door but these only work if you lift up the handle and then remember to turn and remove the key.

Remember-lift, lock and remove.

Paul Harris, Essex Police Staff No 42077939

Essex Watch Liaison Officer for Brentwood, Epping Forest, Harlow and Uttlesford districts

Tel: **07738 736687** (Please avoid leaving phone messages and email me instead.)

Paul.Harris@essex.police.uk Thanks)

You can also find me on TWITTER: Paul Harris EWLO@PaulEssexWatch



Have you an announcement for publication in *The Link*?

Send it to the Editor at robert@arnold-q.uk.

Unless it's commercial it probably will be free.



SCHOOL GOVERNOR VACANCY – March 2021

Federation of Farnham and Rickling Primary Schools

We are looking for a new School Governors. Our school Governing Body is made up of Governors from all walks of life and many come to us through a variety of routes and with a range of different backgrounds, skills and experiences, but they are all volunteers who work together for the benefit of the School and are the link between the School and the community it serves. Being a Governor is a rewarding and effective way of making a voluntary contribution to your community and to the lives of local young people.

Governing Bodies are strategic leaders in schools. The Head Teacher is accountable to the Governing Body whose role is to set the aims and objectives of the school (together with the Head Teacher) in line with national guidelines and to monitor progress.

Have you got?

- An interest in our children's future
- Time, energy and enthusiasm
- A desire to make a difference
- An ability to work as a team
- An interest in the performance of the school.
- A desire to contribute to and represent the community.
- An open and enquiring mind
- The ability to look at issues objectively
- The confidence to ask questions and join in debate.
- A willingness to listen and make informed judgements

Then you could have what it takes to join one of the largest volunteer groups in the country, working with others to get the best for our children.

If you are interested in becoming a governor then a written application including a brief description about yourself and why you would like to join the governing body should be submitted to the contact below.

The Headteacher & Chair of Governors
Federation of Farnham and Rickling
Rickling Primary School
Rickling Green
Saffron Walden
Essex
CB11 3YG

Advertising in
The Link

**reaches every household in Quendon and Rickling at
attractive rates**

This space could be promoting YOUR business

It's just £90 for a whole year!

Contact: Advertising **preferably by e-mail at**

sandra@arnold-q.uk, or telephone 01799 543075



Redundancy Help from Uttlesford Frontline

Job loss through redundancy confronts more and more of us in these uncertain times. And even if it comes as no surprise, its impact cannot be underestimated. More often than not, there will be severe financial consequences, an inevitable blow to self esteem and of course the million dollar question of What Next?

Redundancy is an extremely complex issue, and while employers have a legal obligation to follow correct procedures it is always advisable to make sure you fully understand all the in's and out's of what is happening and are satisfied that your employer is fully compliant with the law.

For instance if you decide to accept an offer of 'suitable alternative employment' within your organisation, your employer is obliged to offer

you a four week trial period without affecting any of your statutory rights. And if there is a suitable alternative job which is not offered to you, then this could be classed as unfair dismissal by an employment tribunal.

If in doubt or unclear about any aspect of the redundancy procedure, then trusted organisations such as Citizens Advice can help. In addition to employment issues, it can

also advise on the inevitable money problems that accompany redundancy and with identifying and applying for available benefits as well as how best to handle debt problems..

Finding new employment is a challenge for anyone facing redundancy. Today's jobs market is highly competitive and you may feel you lack the necessary skills for success. Practical help with job search, CV writing, application letters and interview techniques are offered free of charge by **The Transition Project** in Saffron Walden and the new Employment Support Scheme from the CVSU (Council for Voluntary Service Uttlesford). Their volunteers are trained in negotiating the complexities of the job-seeking market.

Details about all these services plus more information relating to redundancy are instantly accessible from Frontline. This is your comprehensive online library of local resources giving you direct access to specialist organisations that can provide help with many of life's problems - in most cases with the opportunity to self refer.

In addition Frontline has compiled a comprehensive 7-page fact sheet "**Preparing for Redundancy**" (with full contact details) downloadable free of charge.

Visit www.uttlesfordfrontline.org.uk

Emergency Life-saving

Should someone suffer a cardiac arrest or show symptoms of a heart attack e.g. pains in the chest, then your first action should always be to phone the ambulance service on 999. The service will tell you the key code for our Automated External Defibrillator which is in the secure box at the front entrance to Quendon & Rickling Village Hall. Anyone can save a life by using it until an ambulance arrives. In addition you can seek help from any of the volunteers listed below.

Name	Home Telephone	Locality
Alan Price	01799 542527	Northern end - Cambridge Road
Jane Price	01799 542527	Northern end - Cambridge Road
Robert Arnold	01799 543075	Northern end - Cambridge Road
Sandra Arnold	01799 543075	Northern end - Cambridge Road
Andrew Thomson	01799 543253	Northern end - Cambridge Road
Karen Thomson	01799 543253	Northern end - Cambridge Road
Thelma Wilson	01799 543313	Northern end - Cambridge Road
Chris Phillips	01799 542351	Middle - Cambridge Road
Sue Phillips	01799 542351	Middle - Cambridge Road
Nigel Ackerman	01799 540678	Middle - Cambridge Road
Wendy Stannard	01799 541869	Middle - Cambridge Road
Anne Howes	01799 543545	Southern end - Cambridge Road
Joanne Hales	07903 596011	Rickling Green
Janice Hart	01799 541196	Rickling Green/Brick Kiln Lane/Rickling
Clare Willoughby	01799 543637	Rickling Green/Brick Kiln Lane/Rickling



For further information see www.communityheartbeat.org.uk/

Remember: Using the defibrillator can't cause injury. Doing nothing can.



Let's keep in touch! To subscribe to our 'What's On' emails, use this QR code.



Find more information at www.saffronscreen.com

What's On

Following the Government and Village Hall guidelines; The hall can be reopened on May 17 provided there are no further outbreaks of Covid 19. We look forward to seeing everyone again.

Please check with the organiser before setting out for any of the remaining activities.

Event	Date	Time	Place	Notes
Armadillos	Tuesdays (term-time)	09.00	Rickling School	
Rickling Runners	Thursdays	19.30	The Green	
Buffy Playbus	Fridays	09.15-10.30	Rickling Green	Term-time

The Link is produced on behalf of Quendon & Rickling PCC, who do not necessarily share or endorse any opinions expressed by contributors or advertisers.

The Link is delivered free of charge by volunteers to every household in the villages of Quendon and Rickling. It is also available by post and online at: <http://www.quendonandrickling.co.uk>

All correspondence for *The Link* should be addressed to the editor,

Robert Arnold: **preferably by e-mail with attachments if necessary:** robert@arnold-q.uk, or at Talbots, Cambridge Road, Quendon, CB11 3XJ; otherwise telephone 01799 543075

Copy for each month is normally required by the 19th of the preceding month to allow for assembly, printing and delivery.

The Link is assembled using Scribus software and is printed through the generosity of
ALTERNATIVE Managed Services

<http://www.alternative.uk.com/> E-mail: info@alternative.uk.com

Clare's *gents hair stylist*
@ Rickling Green



- ★ Appointments from 7am Mon-Sat
- ★ FREE easy parking
- ★ Fully qualified & insured

Call: 01799 542424
Text: 07791 058406

City & Guilds Qualified

Fly fishing

for rainbow, spartic, tiger and brown trout
in a beautiful private lake less than 10 miles away

Causeway Fly Fishers

Contact: Colin Harris 01799 541622
or David Jaffray 07710 761487

info@causewayflyfishers.co.uk
www.causewayflyfishers.co.uk

Still offering a warm welcome to new members

angli-EAR
Hearing & Tinnitus Solutions

Have you heard?
We've moved!

Find us at our new address:
Audiology House (Cambridge)
15 Woodlands Lane, Great Shelford
Cambridge CB22 5LZ



BOOK ONLINE www.anglihearhearing.co.uk

01223 661399
info@anglihearhearing.co.uk

Advertising in
The Link
reaches every household in Quendon
and Rickling at attractive rates
This space could be promoting
YOUR business
Contact:
Advertising **preferably by e-mail** at
sandra@arnold-q.uk, or telephone
01799 543075

PEASGOOD & SKEATES THE FAMILY FUNERAL SERVICE

*A personal caring service from a
local business, day or night*

Shire Hill and High Street
Saffron Walden
(01799) 523314

*Also at Duxford,
Cambridge and Haverhill*

Free professional bereavement
support available to all our clients

Pre-paid funeral planning

www.peasgoodandskeates.co.uk



- Boiler Servicing & Repairs
- Full Central Heating Systems
- Bathrooms
- Underfloor Heating
- Landlord's Safety Certificates

All work undertaken, fully insured & guaranteed



DD 01799 542920
M 07816 355483



Bespoke Designs
Professional Craftsmen
and much more!
01279 626389
andrewbanks.co.uk

Binwash

We
clean
your
Wheelie
bins!

Commercial & Domestic



**Monthly Cleaning
from just £4.50!**

* Households only

- Professional equipment
- 4 weekly schedule or one-offs
- Same day as waste collection

www.binwash-uk.com
01799 529899
enquiries@binwash-uk.com

ina nelson electrical installer

Female Electrician
• Electrical Installation
• Fault Finding
• Inspection & Testing
• Certification
C&G 2330, 17th Edition, C&G
2391 Test and Inspection.
Part P Registered. NIC EIC
Approved Domestic Installer.

1, Bonnetting Lane, Tel: 01279 777357
Berden, Mob: 07837 420647
Bishops Stortford, inanelson@hotmail.com
Essex, CM23 1AG



Paddy McKenna

**WALDEN
Sweeps**

- Services offered include:
- Chimney and Flue Sweeping
- Wood Burning Stoves
- Open Fires
- Aga/Rayburn
- Bird Nest Removal
- CCTV Examinations

t: 01799 599981
m: 07956 099788
e: paddy@waldensweeps.mysan.co.uk

www.waldenchimneysweeps.co.uk



Electrician

All types of work carried out
Electrical contractor

C D Collins

Crofts View
Newport Road
Wicken Bonhunt
Saffron Walden
Essex, CB11 3UE
Tel/Fax 01799 540194
Mobile: 07831 131 754

Please mention

The Link

when responding to
advertisements here.

An advertisement this size is
only £45 for a whole year!

NICK SHUTES PAINTING AND DECORATING LTD

High quality interior and
exterior redecoration
Woodwork repairs and
replacement

Fascias, soffits and cladding

**01799 542385 or
07885 778213**

www.nickshutesdecorating.co.uk

CHIROPODIST

Mrs Julie Golden

HPC Registered/State Registered
Home Visiting Practice

Est.1994

01279 873492

Mobile 07916 075451

A professional service at a competitive price



More than just a service.



All Domestic & Commercial
works undertaken

www.shelfordheating.co.uk

T: 01223 833426 E: sales@shelfordheating.co.uk

Interested in TIME BANK?

Join our local Time Bank register to offer and receive ad hoc help with every day jobs such as: small gardening issues, dog walking, befriending, cups of tea, baking, light housework, dietary advice, running errands, and much more ...

Contact: Tessa Deriziotis on:

01799 510 525 (work)

07904 890991 (home)

volunteer@volunteeruttlesford.org.uk



Please mention

The Link

**when responding to
advertisements here.**

**An advertisement this size is
only £45 for a whole year!**

Joseph Cullinane Estate Agents

Jamie Price

Partner

T: 01799 219007

M: 07557 949002

Email: jamieprice@josephcullinane.co.uk

Web: <https://www.josephcullinane.co.uk>



Bespoke natural looking ponds

Ecosystem ponds, streams & cascades

Pond Cleaning Service

We aim to be Britain's best pond artists

www.creativecascades.co.uk

01279 771084 / 07889 655908

info@creativecascades.co.uk

CAMWOOD HOME IMPROVEMENTS

Boiler installations and services
Cylinder installations
Heating
Kitchen refurbishments
Garage conversions

References available - Fully insured
Free advice & estimates - Competitive rates
Office: 01279 814296 Mobile: 07714 300920

Email: camwoodhomeimprovements@outlook.com
Gas safety registered engineer



TONY WOOD

Qualified Registered Electrician

All electrical works undertaken

Re-wires, new circuits, extensions
Replacement Consumer Units
Electric showers, heating, additional sockets
Internal and external lighting

Free advice & estimates
References available
Competitive rates
Fully insured

Please ring Tony on
07714 300920
01279 814296

Or e-mail camwoodhome@outlook.com
Electrical Safety Register Approved Contractor



Quendon OSTEOPATHY

Jacolin Sheaf (Lampton) D.O.

4a Red Cottages,
Cambridge Road, Quendon,
Saffron Walden, Essex CB11 3XH

Structural Osteopathy,

Cranial Osteopathy.

Treatment of back and neck pain,
muscle and joint pain,
Tension headaches,
trapped nerves and sports injuries.

One-to-one Pilates instruction.

Specialist Clinic for
pregnant mothers,
babies and children.

Tel: 01799 543444

Email: info@quendonosteopathy.co.uk

Web: www.quendonosteopathy.co.uk

**ONSITE PARKING
AT THE NEW CLINIC**



**Advertising in
*The Link***

**reaches every household in
Quendon and Rickling at
attractive rates**

This space could be promoting

YOUR business

Contact:

**Advertising preferably by e-mail
at sandra@arnold-q.uk, or
telephone 01799 543075**